

# How to use PANBIO COVID-19 rapid antigen tests

## BEFORE



Blow your nose and wash your hands with soap

## 1 SET UP



Fill the tube with the test liquid **up to the first line**

Place filled test tube in the assembled test tube rack

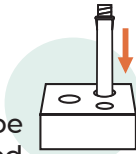

## 2 COLLECTION

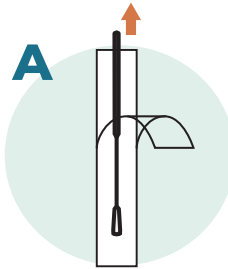

Peel down and remove nasal swab

**B** Insert nasal swab up to **1 inch (2.5 cm)** from edge of nostril

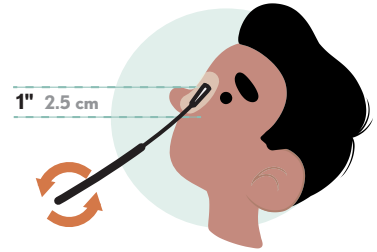

Roll **5 times** in **each nostril** (right and left nostril)

## 3 PREPARATION

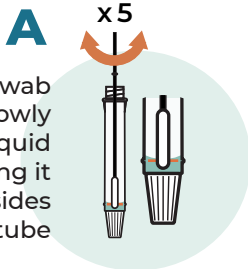

Swirl the swab gently and slowly in the liquid **5 times**, pressing it against the sides of the tube

**B** Gently pinch the tube to extract the fluid while removing the swab

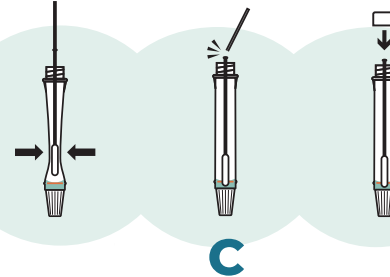

Break the swab at the break-point where there is an indentation and leave the swab in the tube

**D** Screw the blue cap onto tube

## 4 TESTING

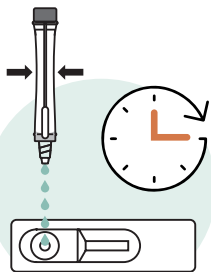

Place **5 drops** in the rapid response cartridge and wait **15 minutes**, no more

\* Place the test on a flat surface and do not touch it during the waiting time

Here is an example of a positive test, negative and an invalid test

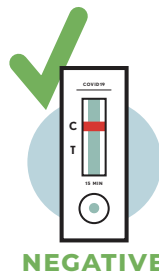

**NEGATIVE**

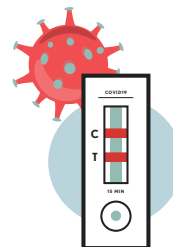

**POSITIVE**

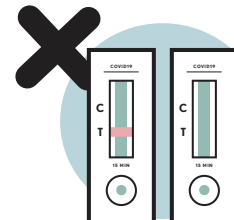

**INVALID**

Redo the nasal swab with a new kit.

If the test result is positive: Please inform your PSO.